



Radio Frequency Systems' line of high performance coaxial cable connectors are designed specifically to provide the highest quality connector-cable interface while simplifying and speeding up the attachment of connectors to CELLFLEX® coaxial cables. RFS connectors are fully tested for mechanical and electrical compliance specifications. They are available in all popular cable sizes in a variety of mating interfaces. To join two cables with EIA connectors, two identical socket connectors are installed on either end of the cables to be joined, and a coupling element is used to make the connection of the center conductor. The coupling element must be ordered separately with the exception of the S-Line male versions that have a captivated coupling element. Connectors are available in sizes matching the nominal cable size. EIA connectors provide optimal power handling for the complete transmission line system.

FEATURES / BENEFITS

- Single-piece design for Fast and Easy Installation
Reliable and simple attachment avoids unnecessary connector adjustments and provides outstanding performance every time. Saves time and provides cost savings.
- Robust Mechanical Design
Low and consistent intermodulation performance guarantees outstanding system sensitivity.
- Excellent Electrical Performance
Consistent and repeatable low VSWR improves overall system performance and margin and reduces mismatch losses
- Totally Waterproof according to IP 68
Assures safe, long term operation in the harshest of environments.



RAPID FIT™ Connectors

Technical features**GENERAL SPECIFICATIONS**

| | | |
|------------------------|--|------------------------------------|
| Transmission Line Type | | Coaxial Cable |
| Cable Size | | 7/8 |
| Cable Type | | Foam Dielectric |
| Model Series | | LCF78-50A-Series, RCF78-50A-Series |
| Connector Interface | | 1-5/8" EIA |
| Connector Type | | RAPID FIT™ |
| Sealing Method | | Sealing compound ¹) |
| Gender | | None |

ELECTRICAL SPECIFICATIONS

| | | |
|-----------------------------------|-----------|--|
| 3rd Order IM Product @ 2x20 Watts | dBc | <-156 |
| Maximum Frequency | GHz | 3.3 |
| VSWR, Return Loss | VSWR (dB) | 0 < f ≤ 1.0 GHz: 1.02 (40) 1.0 < f ≤ 2.7 GHz: 1.03 (36.6) 2.7 < f ≤ 3.7 GHz: 1.06 (30.7) |

MECHANICAL SPECIFICATIONS

| | | |
|--------------------------|---------|---------------|
| Plating Outer/Inner | | Silver/Silver |
| Length | mm (in) | 110 (4.3) |
| Outer Diameter | mm (in) | 90 (3.5) |
| Inner Contact Attachment | | Spring Finger |
| Outer Contact Attachment | | Spring Finger |



ACCESSORIES

| | | |
|-------------------|---------|---------------|
| Wrench size front | mm (in) | 30 (1-3/16) |
| Wrench size rear | mm (in) | 30 (1-3/16) |
| Trimming Tool | | TRIM-Series-A |

TESTING AND ENVIRONMENTAL

| | | |
|------------------------------|--------------------------|----------|
| Waterproof Level | | IP68 |
| Sealing Volume, cm3 (ounces) | cm ³ (ounces) | 7 (0.26) |

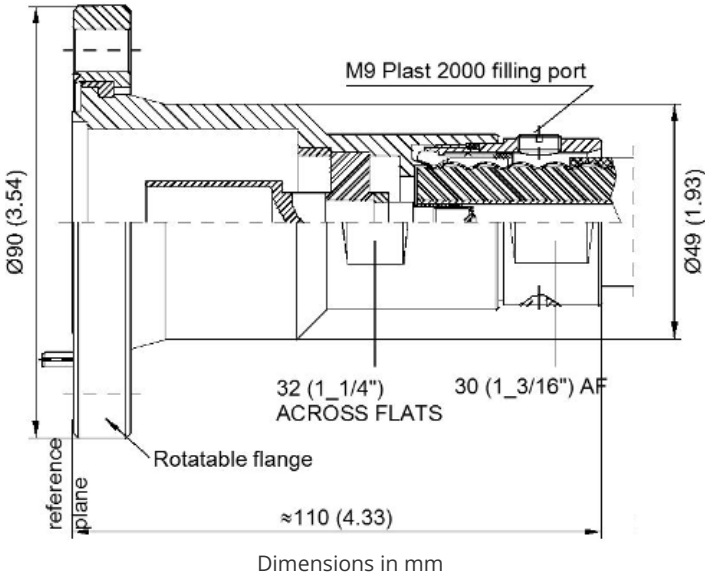

External Document Links
[Installation Instruction](#)

Notes
1) The sealing compound must be ordered separately.