

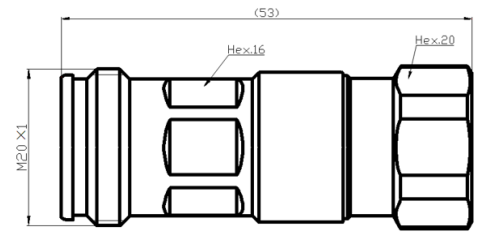

ECO Series connectors are designed for use with CELLFLEX® cables.

FEATURES / BENEFITS

- Cost effective two-piece design for safe and easy installation
- Superior electrical performance for consistent and repeatable VSWR i.e. ensure network system performance
- Waterproof to IP 67 i.e. no downtime risk, secures revenue
- RoHS (EU) and CRoHS (China) compliant i.e. can be used on a global basis

**Technical features****GENERAL SPECIFICATIONS**

Transmission Line Type		Coaxial Cable
Cable Size		1/2
Cable Type		Foam Dielectric
Model Series		LCF12-50 Series
Connector Interface		4.3-10
Connector Type		ECO Series
Sealing Method		O-ring
Gender		Female

ELECTRICAL SPECIFICATIONS

Nominal Impedance, ohms	Ohm	50
3rd Order IM Product @ 2x20 Watts	dBc	-155 @1800MHz
Maximum Frequency	GHz	6
VSWR, Return Loss	VSWR (dB)	690 < f ≤ 960MHz: 1.10 (26.4) 1700 < f ≤ 2700MHz: 1.13 (24.3) 2700 < f ≤ 3000MHz: 1.15 (23.1) 3000 < f ≤ 5000: 1.20 (20.8)

MECHANICAL SPECIFICATIONS

Plating Outer/Inner		Trimetal/Silver
Length	mm (in)	53 (2.087)
Outer Diameter	mm (in)	22 (0.87)
Inner Contact Attachment		Spring Finger
Outer Contact Attachment		Spring Finger

ACCESSORIES

Wrench size front	mm (in)	16
Wrench size rear	mm (in)	20

TESTING AND ENVIRONMENTAL

Waterproof Level		IP67
------------------	--	------

External Document Links

[10000037510-01_install-instr_conn-eco_lcf12.pdf](#)

Notes