



RFS RADIO FREQUENCY SYSTEMS
Standard Grounding Kit for SCF 12

EAR-12-S 



15509606

Contents
1 pcs

Manufactured
YY/WW/ZZ

Installation Instruction

10000007658-02
for CELLFLEX® cables SCF12-50J & JFN
Not suitable for cables with aluminium outer conductor!

These instructions are written for qualified and experienced personnel. Please study them carefully before starting any work. Any liability or responsibility for the results of improper or unsafe installation practices is disclaimed. Please respect valid environmental regulations for assembly and waste disposal. Always make sure to use appropriate personal protection!

The kit contains:

- 1 x Earthing clamp with screw M4x8
- 1 x Butyl sealing compound
- 1 x Self bonding/fusing tape



Subject to change without prior notice

Attention!
Install grounding kit only where the cable runs straight and between two close fixation points.



Clean the jacket at the desired grounding point and carefully cut out a strip of 18-20mm (0.7-0.8in) e.g. with a knife. Do not damage the outer conductor!

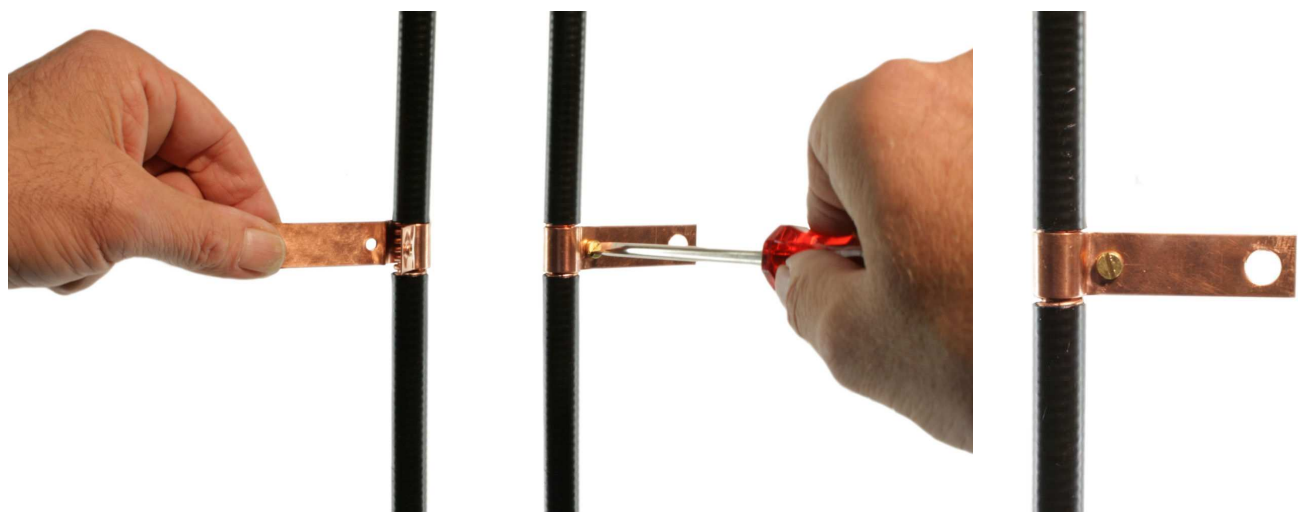

Bend open the earthing clamp a little bit, align the grounding kit body to the jacket opening and wrap it around the cable.



EAR-Standard Grounding Kit

for CELLFLEX® Coaxial Cables SCF 12
EAR-12-S

Installation Instruction

10000007658-02

for CELLFLEX® cables SCF12-50J & JFN

Not suitable for cables with aluminium outer conductor!

Keep the cable in a straight line (support with the other hand) when inserting the screw and tightening it with a screwdriver until the clamp is fully closed.

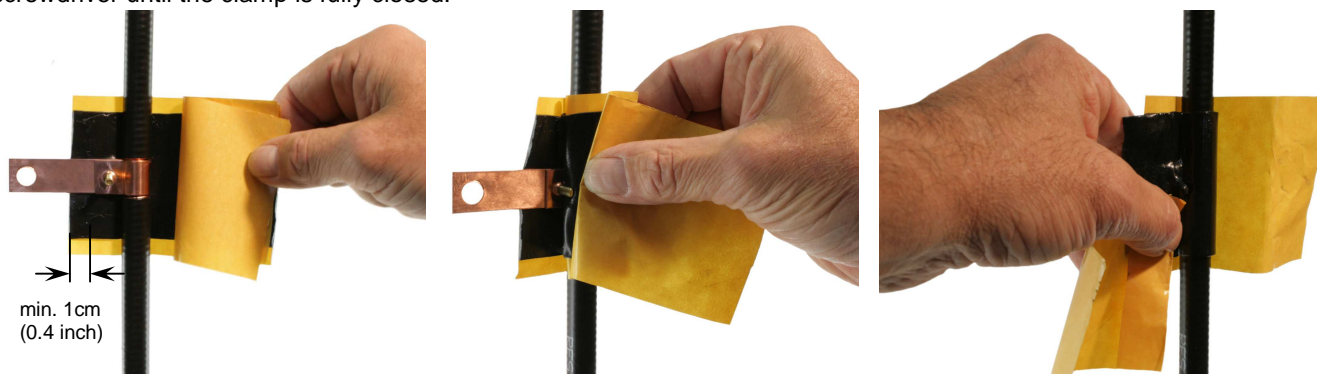

Remove one of the covering papers from the Butyl sealing compound and form it equally around the cable and the earthing clamp – make sure that the butyl tape overlaps the short copper leg (both ends of the butyl tape ends on the long copper leg). Carefully press all compound together, tight to the cable and earthing clamp (without any air bubbles inside). Press and form it tightly to cable and earthing clamp. Perform the job without humidity to prevent the sealing from trapping moisture and dirt. Moisture and dirt prevent proper taping.

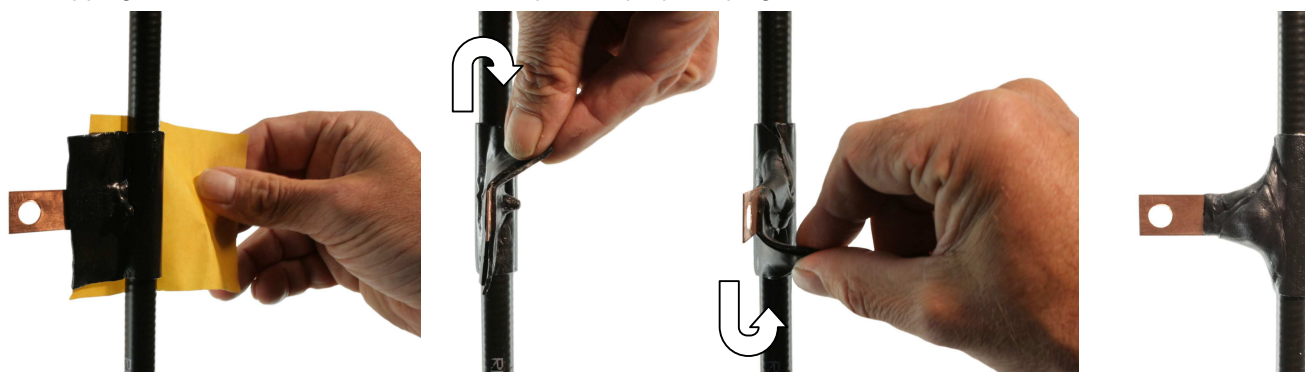

Remove the second covering paper. Fold both overlapping edges in opposite direction of the screw head. Press and form the butyl sealing compound over the complete of-site screw thread to a seamless transition.

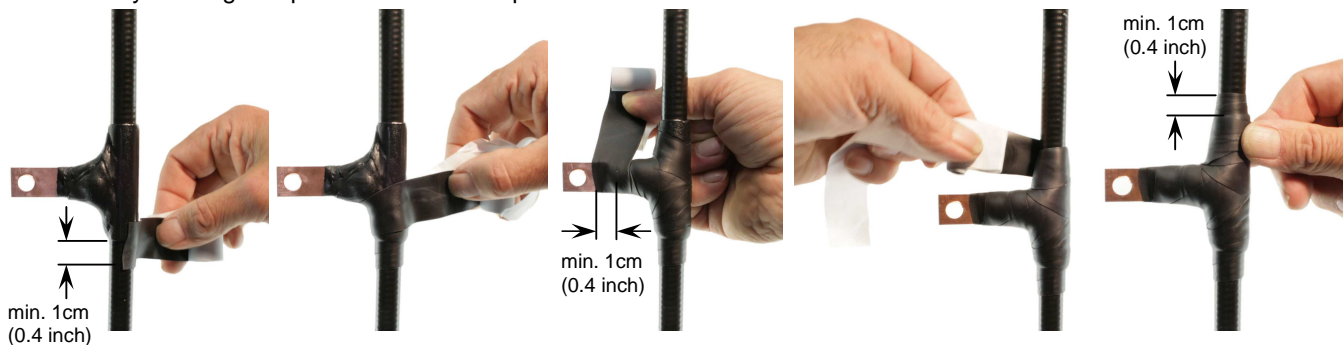

Remove the liner of the self-fusing tape at the beginning. Apply the self-fusing tape to the cable jacket starting on bottom side (min. 1cm/0.4 inch) before the butyl tape. Stretch the tape always (~ 50%) during wrapping around the cable. Let each turn overlap the previous turn about 50% to form a roof tile looking cover – last layer from bottom to top. Wrap tight the complete cable part and the earthing outlet until the entire grounding kit is properly covered. Do not touch the sealing areas (especially in parts of adhesion) of the tape with fingers. Stretch also the end of the tape and fix the end by pressing/rubbing for few seconds.

Straighten the Grounding wire in direction to the grounding point (shortest way as possible).
The fixation of the wire is recommended.
Note the applicable standards & local rules.

