

# SC2/SCX2 ANTENNA

## Installation Instructions



NMT-10-1159-01

1 / 2

Offset left

Generic View  
(Standard Interface)

Offset right

### Required tools

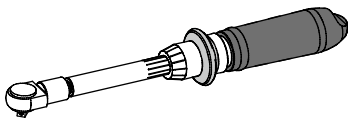

3...45N.m

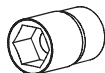

10/17



4

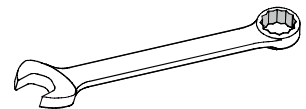

10/17

It is important to mount the antenna exactly as described in this installation instruction.  
The installed antenna shall be inspected once per year by qualified personnel.  
RFS disclaims any responsibility for the result of improper or unsafe installation.  
This installation instruction has been written for qualified, skilled personnel.

We reserve the right to alter details, especially with respect to technical improvement

# SC2/SCX2 ANTENNA

## Installation Instructions



NMT-10-1159-01

2 / 2

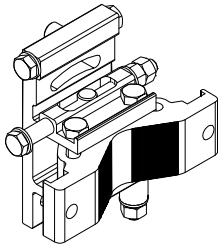

Mount x1

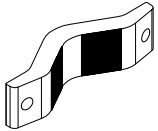

Clamp x1

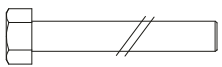

M10x140 x2

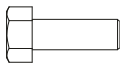

M10x30 x3



M8x10 x1



Washer A10,5 x5



Washer W10 x3



Nut M10 x4



Nut M10 x2



Rain cap x1



Grease x1

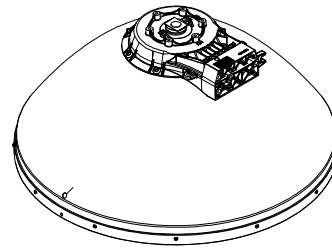

Reflector + feed x1

Customer Interface

