

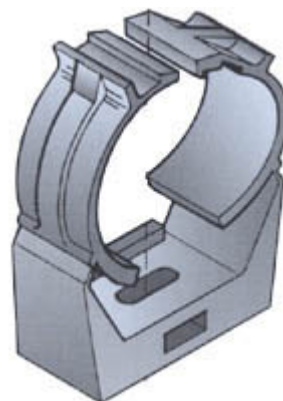

Clic Clamp, 1/2" ALF,RCF,RLK polyamide black, halogen free  
fire class UL94HB

**FEATURES / BENEFITS**

Safe and efficient installation of RADIAFLEX<sup>®</sup> cable with clic-clamps. Simple mounting by using wall plugs and screws. Simply push in by hand, clamp will grip and lock by applying slight pressure.



clic\_clamp\_TI

**External Document Links****Notes**

\* valid for all cable versions

**Technical features****GENERAL SPECIFICATIONS**

Product Line		Radiating Cable Accessories
Product Type		Hanger
Hanger Type		Clic clamp
Transmission Line Type		ALFU RLK* RCF12-50*A HCA12-50 RHCA12-50
Cable Type		Air Dielectric Radiating Cable
Color		Black

**MECHANICAL SPECIFICATIONS**

Cable Size		1/2
Number of Cable / Waveguide Runs		1
Material		Polyamide

**TESTING AND ENVIRONMENTAL**

Fire Class		UL94 HB
------------	--	---------

**TEMPERATURE SPECIFICATIONS**

Installation Temperature	°C (°F)	-20 to 80 (-4 to 176 )
Operation Temperature	°C (°F)	-50 to 85 (-58 to 185 )
Storage Temperature	°C (°F)	-50 to 85 (-58 to 185 )

**PACKAGING INFORMATION**

Package Quantity		500
------------------	--	-----



**CC-12-2**

Clic clamp for RADIAFLEX<sup>®</sup> 1/2" (for ALF, RCF RLK)

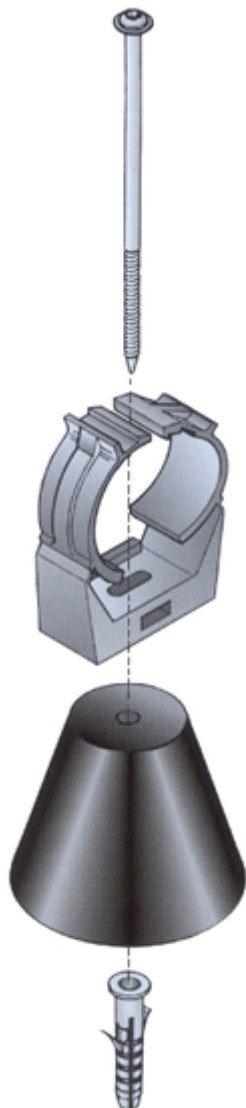



**CC-12-2**

Clic clamp for RADIAFLEX® 1/2" (for ALF, RCF RLK)

