



The TERP-43-product family consists of coaxial loads supporting an operational frequency band from 698MHz up to 3800MHz. The products are ideally suited for termination of unused ports in distributed antenna systems or in RADIAFLEX® radiating cables systems. The loads feature an outstanding PIM performance to avoid interferences in 3G / 4G / 5G communication systems.

**FEATURES / BENEFITS**

- Wideband coaxial load supporting all wireless services in the frequency band 698-3800MHz
- Ideally suited for 2G / 3G / 4G / 5G wireless communication networks
- PIM optimized design to avoid network interferences
- 4.3-10 female interface

NO IMAGE  
AVAILABLE**Technical features****GENERAL SPECIFICATIONS**

Product Type		Load
Techn. Application		Indoor

**ELECTRICAL SPECIFICATIONS**

Frequency Range	MHz	698 - 3800
Impedance	Ohm	50
Intermodulation (IM3)		-160dBc @ 2 x 37dBm
Max. VSWR / Return Loss, dB	VSWR/dB	1.30/17.7
Total Input Power	W	5

**MECHANICAL SPECIFICATIONS**

Input Connector Type		4.3-10 female
Diameter	mm (in)	35 (1.378)
Length	mm (in)	153.5 (6.024)

**TEMPERATURE SPECIFICATIONS**

Temperature Range	°C (°F)	-25 to 65 (-13 to 149)
Environmental Class		Indoor

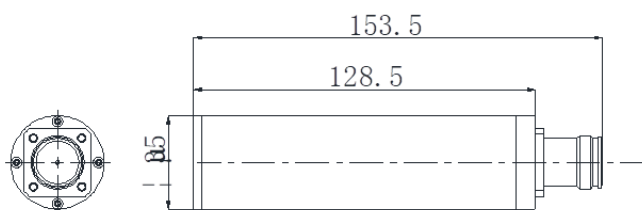
**External Document Links****Notes**

Derated power by -1.5%/°C above 50°C