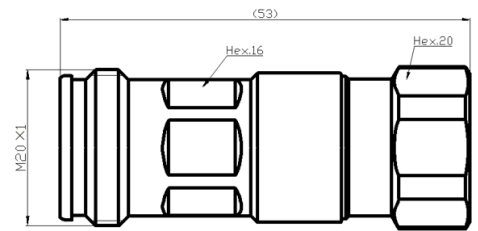

**43F-LCF12-ECO****4.3-10 Female Connector for 1/2" Coaxial Cable, ECO-Series**

ECO Series connectors are designed for use with CELLFLEX® cables.

FEATURES / BENEFITS

- Cost effective two-piece design for safe and easy installation
- Superior electrical performance for consistent and repeatable VSWR i.e. ensure network system performance
- Waterproof to IP 67 i.e. no downtime risk, secures revenue
- RoHS (EU) and CRoHS (China) compliant i.e. can be used on a global basis

**Technical features****GENERAL SPECIFICATIONS**

| | | |
|------------------------|--|-----------------|
| Transmission Line Type | | Coaxial Cable |
| Cable Size | | 1/2 |
| Cable Type | | Foam Dielectric |
| Model Series | | LCF12-50 Series |
| Connector Interface | | 4.3-10 |
| Connector Type | | ECO Series |
| Sealing Method | | O-ring |
| Gender | | Female |

ELECTRICAL SPECIFICATIONS

| | | |
|-----------------------------------|-----------|---|
| Nominal Impedance, ohms | Ohm | 50 |
| 3rd Order IM Product @ 2x20 Watts | dBc | -155 @1800MHz |
| Maximum Frequency | GHz | 6 |
| VSWR, Return Loss | VSWR (dB) | 690 < f ≤ 960MHz: 1.10 (26.4) 1700 < f ≤ 2700MHz: 1.13 (24.3) 2700 < f ≤ 3000MHz: 1.15 (23.1) 3000 < f ≤ 5000: 1.20 (20.8) |

MECHANICAL SPECIFICATIONS

| | | |
|--------------------------|---------|-----------------|
| Plating Outer/Inner | | Trimetal/Silver |
| Length | mm (in) | 53 (2.087) |
| Outer Diameter | mm (in) | 22 (0.87) |
| Inner Contact Attachment | | Spring Finger |
| Outer Contact Attachment | | Spring Finger |

ACCESSORIES

| | | |
|-------------------|---------|----|
| Wrench size front | mm (in) | 16 |
| Wrench size rear | mm (in) | 20 |

TESTING AND ENVIRONMENTAL

| | | |
|------------------|--|------|
| Waterproof Level | | IP67 |
|------------------|--|------|

External Document Links

[10000037510-01_install-instr_conn-eco_lcf12.pdf](#)

Notes