



ECO Series connectors are designed for use with CELLFLEX® cables.

**FEATURES / BENEFITS**

- Cost effective two-piece design for safe and easy installation
- Superior electrical performance for consistent and repeatable VSWR i.e. ensure network system performance
- Waterproof to IP 67 i.e. no downtime risk, secures revenue
- RoHS (EU) and CROHS (China) compliant i.e. can be used on a global basis

**Technical features****GENERAL SPECIFICATIONS**

Transmission Line Type		Coaxial Cable
Cable Size		7/8
Cable Type		Foam Dielectric
Model Series		LCF78-50 Series
Connector Interface		7/16
Connector Type		ECO Series
Sealing Method		O-ring
Gender		Female

**ELECTRICAL SPECIFICATIONS**

Nominal Impedance, ohms	Ohm	50
3rd Order IM Product @ 2x20 Watts	dBc	-155
Maximum Frequency	GHz	5
VSWR, Return Loss	VSWR (dB)	DC < f ≤ 1000MHz: 1.10 (26.4) 1700 < f ≤ 2700MHz: 1.13 (24.3) 2700 < f ≤ 3000MHz: 1.15 (23.1) 3000 < f ≤ 5000: 1.30 (17.7)

**MECHANICAL SPECIFICATIONS**

Plating Outer/Inner		Trimetal/Silver
Length	mm (in)	53.5 (2.106)
Outer Diameter	mm (in)	36.5 (1.437)
Inner Contact Attachment		Spring Finger
Outer Contact Attachment		Spring Finger

**ACCESSORIES**

Wrench size front	mm (in)	32
Wrench size rear	mm (in)	32

**TESTING AND ENVIRONMENTAL**

Waterproof Level		IP67
------------------	--	------



## 716F-LCF78-ECO

7/16 Female Connector for 7/8" Coaxial Cable, ECO-Series

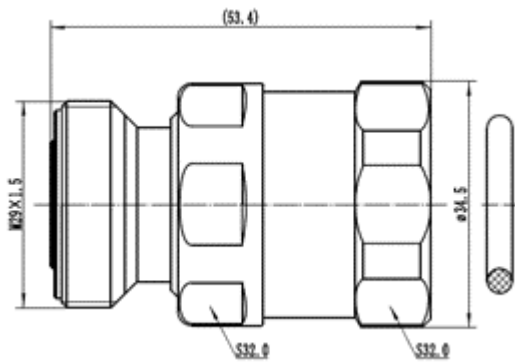

### External Document Links

[10000036998-01\\_inst\\_con\\_lcf78-eco.pdf](#)

### Notes