



Brass made flanging die for use with FLEXWELL® waveguide E380, compact tool, abrasion resistant sawing jig

FEATURES / BENEFITS

Elliptical Waveguide installation

- The flanging die in conjunction with the flanging tool simplifies the installation
- The use of the tool guarantees a safe and proper installation of the Waveguide connector

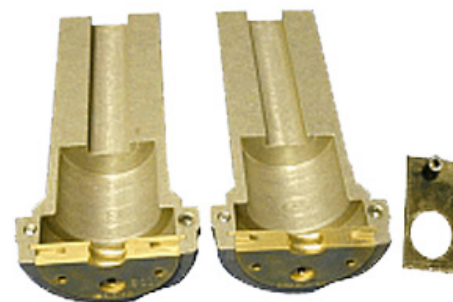

Technical features

STRUCTURE

Product Line		Elliptical Waveguide Accessories
Product Type		Flanging Tool
Transmission Line Type		E380
Cable Size		Size C
Type of Tool		Flanging Die
Size		Size C

ACCESSORIES

Required Tool		Basic Compact Tool : FTOOL-C105380
---------------	--	------------------------------------

MECHANICAL SPECIFICATIONS

Material		Aluminium / Brass
Length	mm (in)	165 (6.5)
Height	mm (in)	78 (3.07)
Width	mm (in)	78 (3.07)

PACKAGING INFORMATION

Package Quantity		1
Weight per piece	kg (lb)	0.86 (1.9)

External Document Links

Notes

Applicable for connectors with IEC flanges