



Surge arrestors are designed to protect wireless base stations, switching centers and transmission line from the damaging effects of extreme high voltage surges caused by lightning strikes. Lightning strikes, even on grounded systems, can implant crushing voltages on RF transmission lines, creating voltage spikes on the center conductor of coaxial cable and putting the network out of commission. The new RFS lightning protection devices are designed and tested to the most demanding specifications. They are rated to protect against both direct and indirect multiple strikes in the harshest environments imaginable. Their rugged construction utilizes solid metal housings, beryllium-copper contacts and superior plating, which results in outstanding system protection and operating continuity.

FEATURES / BENEFITS

- Broadband operation DC to 2.7 GHz
- DC continuity on center conductor for reliable operation
- Replaceable gas capsules for easy maintenance
- compliancy to IEC 61643-21
- IP protection level: IP67
- **Delivered without arrestor (gas capsules)**
 - **UC90** - 90 V gas discharge arrestor
 - **UC230** - 230 V gas discharge arrestor
 - **UC600** - 600 V gas discharge arrestor
 - **UC900** - 900 V gas discharge arrestor



picture shows NMNF-UCxxx-01 for illustration

Technical features**STRUCTURE**

Product Line		Coaxial Cable Components
Product Type		Surge Arrestor
Surge Arrestor Type		Gas Capsule

MECHANICAL SPECIFICATIONS

Configuration		Bulkhead
Connector A		N Female
Center Contact Connector A		copper alloy / silver plated
Outer Contact Connector A		copper alloy / silver plated
Connector B		N Female
Center Contact Connector B		copper alloy / silver plated
Outer Contact Connector B		copper alloy / silver plated
Body		copper alloy / nickel plated
Dielectric		PTFE
Gasket		Silicone rubber
Sealing class		IP67 per EN 60529 (interface connected with appropriate gasket)
Mounting / Grounding		Bulkhead; Thread for grounding M5

**ELECTRICAL SPECIFICATIONS**

Frequency Range - MHz		DC - 2700
VSWR, Return Loss	VSWR (dB)	0-400 MHz: 1.05 400-2000 MHz: 1.10 2000-2400 MHz: 1.15 2400-2700 MHz: 1.2
Insertion Loss, dB (Max)	dB	0.05 dB @ 0 to 400 MHz 0.10 dB @ 400 to 1000 MHz 0.20 dB @ 1000 to 2000 MHz 0.30 dB @ 2000 to 2400 MHz 0.40 dB @ 2400 to 2700 MHz
Power handling		Power handling depends on gas capsule 20W with UC90 180W with UC230 1200W with UC600
Surge current handling capability		25 kA single (test pulse 8/20 μ s)
Residual pulse		350 μ J (test pulse 4 kV 1.2/50 μ s and 2 kA 8/20 μ s)

TEMPERATURE SPECIFICATIONS

Operation Temperature	°C (°F)	-45 to 85 (-49 to 185)
-----------------------	---------	------------------------

ACCESSORIES

Spare Part / Useful Accessories		UC90 : 90V gas discharge arrestor br />UC230 : 230V gas discharge arrestor br />UC600 : 600V gas discharge arrestor br />UC900 : 900V gas discharge arrestor
---------------------------------	--	--

PACKAGING INFORMATION

Package Quantity		1
Weight	kg (lb)	0.13 (0.287)

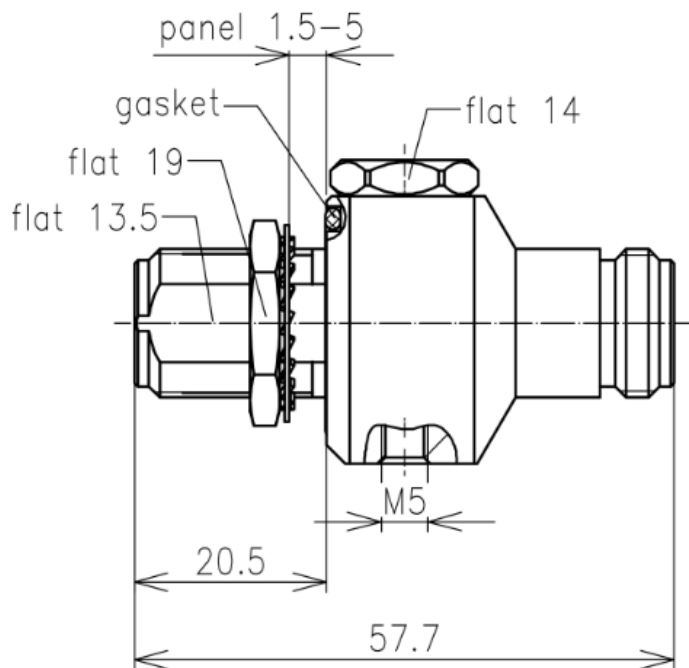

All dimensions are in mm; tolerances according to ISO 2768 m-H

External Document Links

Notes

Delivered without arrestor.