



TUBE-02-G18

Gas inlet 8 mm to thread G1/8

Male hose adapter conical

FEATURES / BENEFITS

suitable with hose TUBE-02-050M, hoses delivered with GOBI77A and GIBSONFX4



Technical features

GENERAL SPECIFICATIONS

Product Type		Distribution
--------------	--	--------------

MECHANICAL SPECIFICATIONS

Material		CW614N und CW617N; polished and nickel-plated
Size		LW=9mm; H=8mm; L1=19mm; L2=31,5mm; sw=12
Thread		R 1/8; conical thread DIN EN ISO 10226
Output Fitting		8 mm
Weight	Kg	0.01

ENVIRONMENTAL

Ambient Temperature Range	°C	max. 150
Operating Pressure	Bar	max. 60

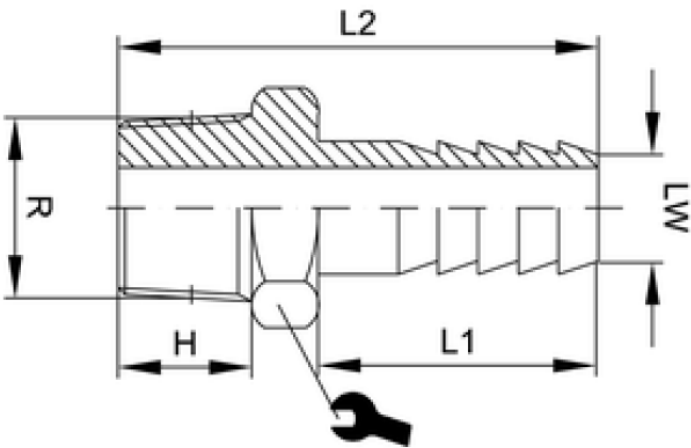

External Document Links

Notes