



N-Adapter to PDR140, female gasket and screw kit enclosure

FEATURES / BENEFITS

Waveguide installation

- The rectangular waveguide component provides simple installation in particular difficult cases
- The flange adapter provides proper matching of rectangular waveguide flanges to N-female connector
- It provides outstanding electrical performance

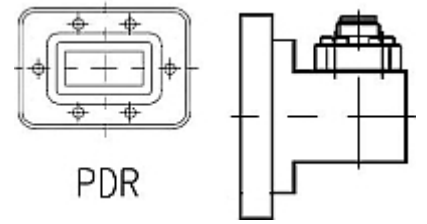

Coax transition for R120 and smaller waveguides

Technical features

STRUCTURE

| | | |
|---|--|---|
| Type of Rectangular Waveguide Component | | Waveguide to Type N Female Coax Adapter |
| Waveguide Size IEC (EIA) | | R140 (WR62) |
| Coaxial Interface | | N-female |
| Flange | | PDR140 |
| Flange Finish | | Brass un-plated |

ELECTRICAL SPECIFICATIONS

| | | |
|---------------------------------|-----------|-------------|
| Frequency Range | GHz | 11.9 - 18 |
| Minimum Return Loss (max. VSWR) | dB (VSWR) | 19.1 (1.25) |

MATERIAL

| | | |
|----------|--|-------|
| Material | | Brass |
| Color | | Black |

PACKAGING INFORMATION

| | | |
|------------------|--|---|
| Package Quantity | | 1 |
|------------------|--|---|

External Document Links

Notes